

DIVERSION ROUTES

The Borough
 Itchell Lane
 Hyde Lane
 Swanthorpe Lane
 Well Road
 & Vice Versa

KEY

- Traffic Barrier
- Traffic Cones
- Traffic Sign Direction
- Ped Barriers
- Works Area
- Safety Zone

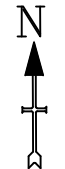
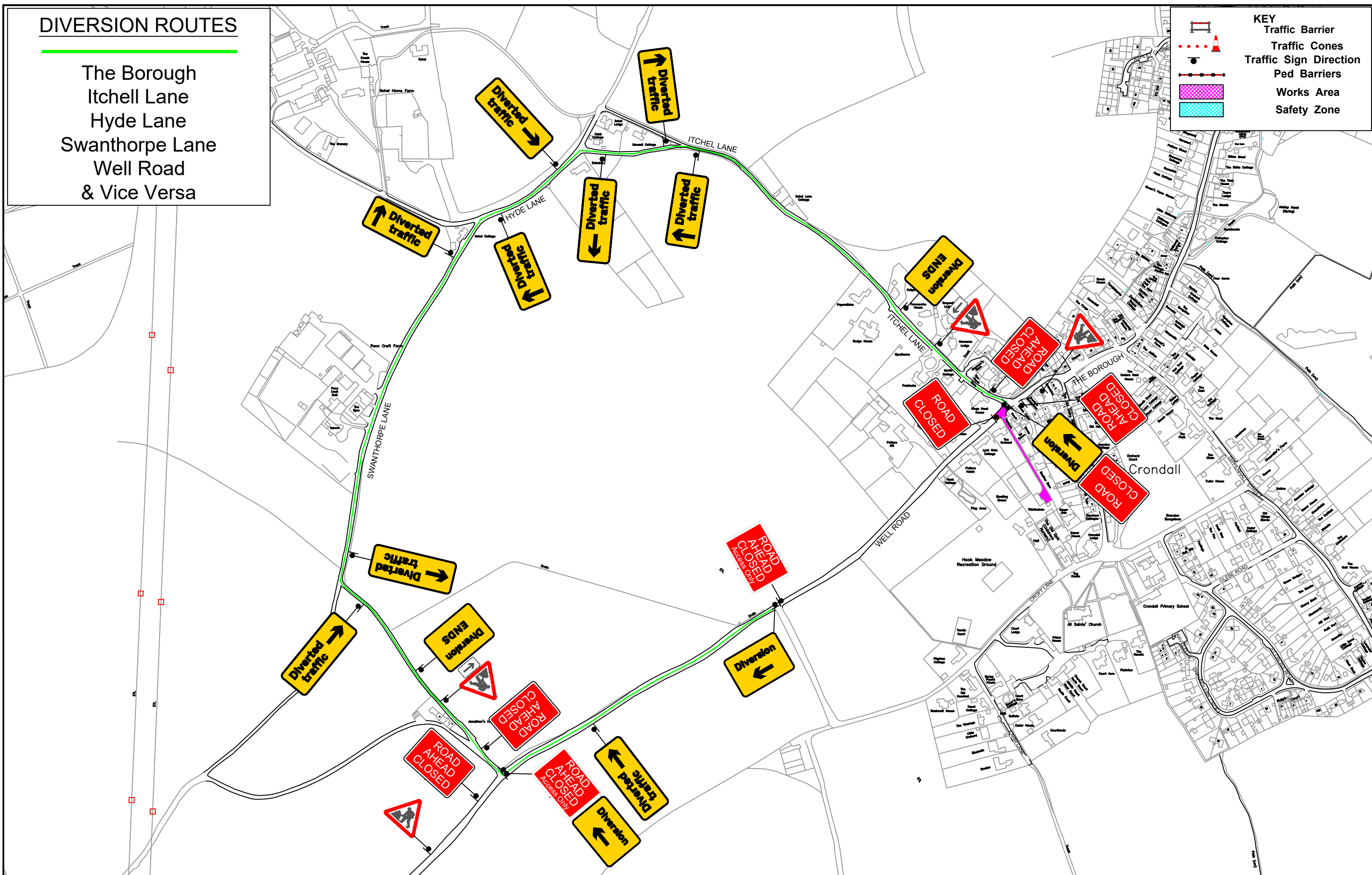

Well Road
 Hampshire
 GU10 5PW



Managers House
 Waylands Treatment Works
 Molesey Road, Hersham, Walton on Thames,
 Surrey KT12 3PB
 Tel: 0800 6444 654
 Web: www.tglgroup.co.uk
 Email : tmdrawings@tglgroup.co.uk

- 1) TEMPORARY TRAFFIC MANAGEMENT TO BE SET OUT IN ACCORDANCE WITH CHAPTER 8 AND SAFE WORKING PRACTICES.
- 2) ALL BUS, PARKING AND LOADING BAYS SHOULD BE SUSPENDED WITH THE RELEVANT AUTHORITY PRIOR TO COMMENCEMENT OF WORK.
- 3) WORKS VEHICLES TO BE PARKED WITHIN WORKS AREA.
- 4) TM WILL COMPLY WITH THE SAFETY AT STREET WORKS AND ROAD WORKS CODE OF PRACTICE

DATE DRAWN	07.04.21	Drawing No.	
DRAWN BY	TGL DS		
CHECKED BY	TGL LE		1127.58
SCALE	N.T.S.		